

# **Petro 3003**

## **Quick Guide**

## **VOLUTANK**

(Without SAFE, with wet hose, with collector draining, with company select)

Softwareversion PYRAMIDE 2.5.x

KBA 210327

**PLEASE NOTE**

*This document is a short version of the product operation. It must be kept in the immediate vicinity of the device so that access to it is possible at any time.*

*To be observed safety and more detailed instructions, see the operation manual.*

*The current version can be downloaded from [www.bartec.de](http://www.bartec.de) or requested from BARTEC BENKE GmbH.*

# Loading without SAFE

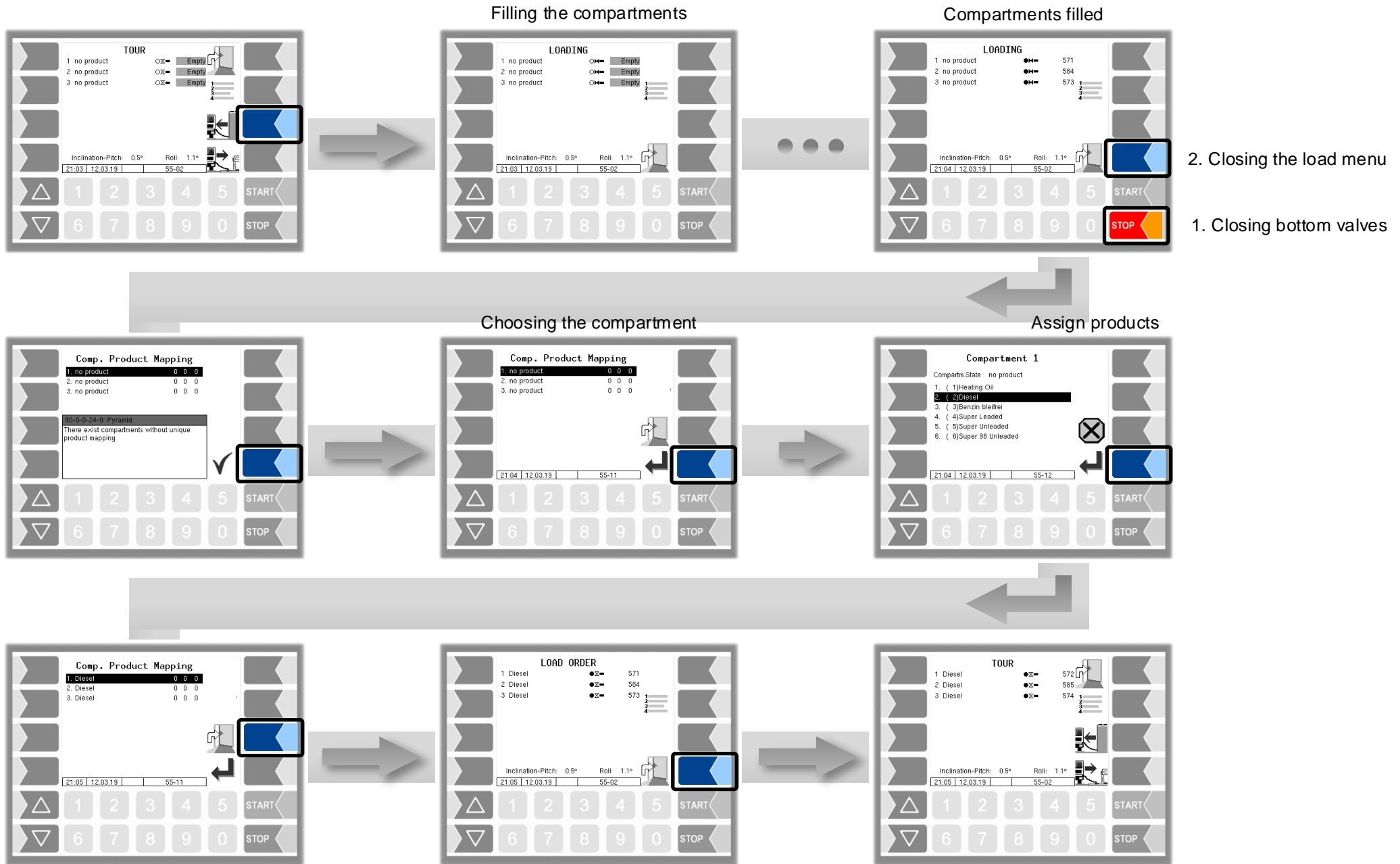

# Loading with company select

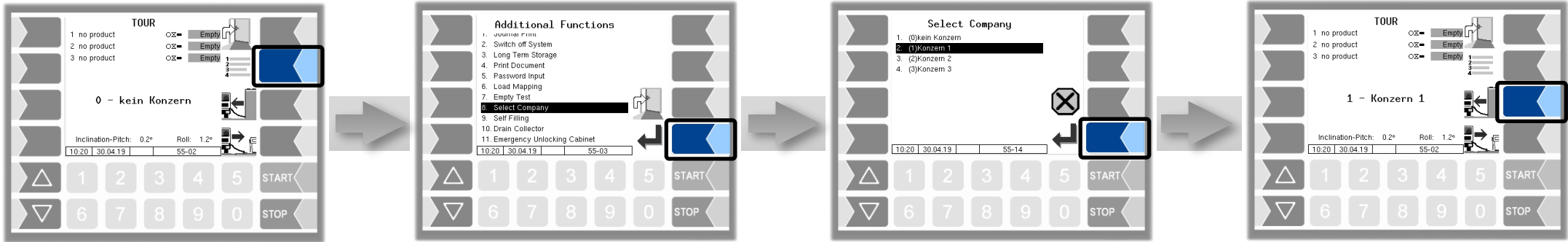

## Filling the compartments

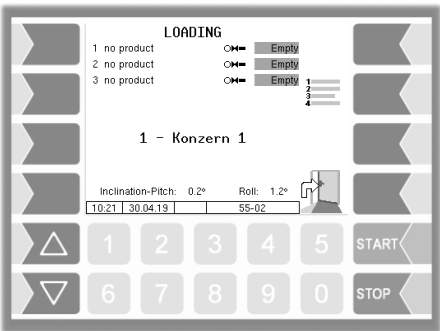

## Compartments filled

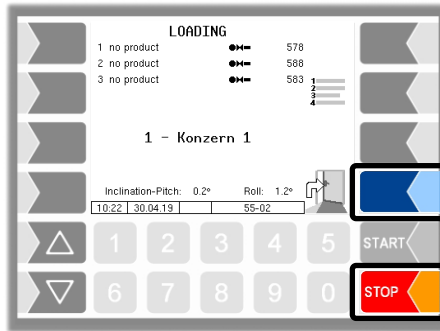

## 2. Closing the load menu

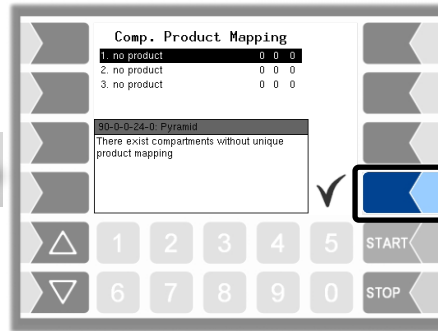

## 1. Closing bottom valves

## Choosing the compartment

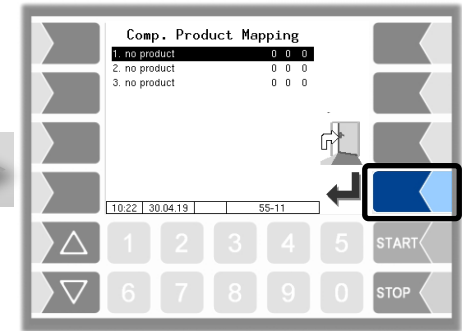

## Assign products

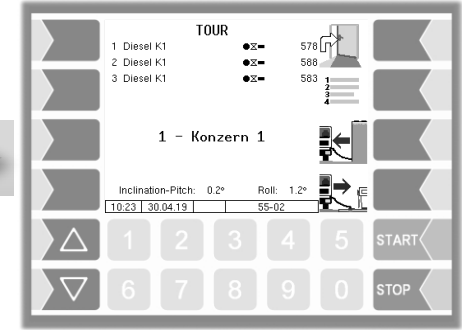
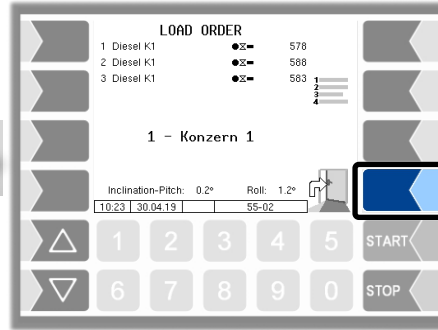
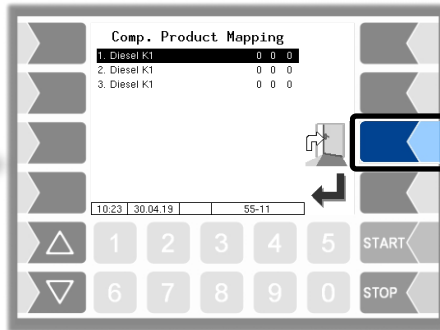
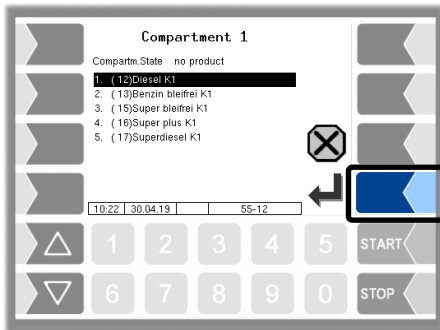

# Delivery without SAFE



# Wet hose delivery parallel

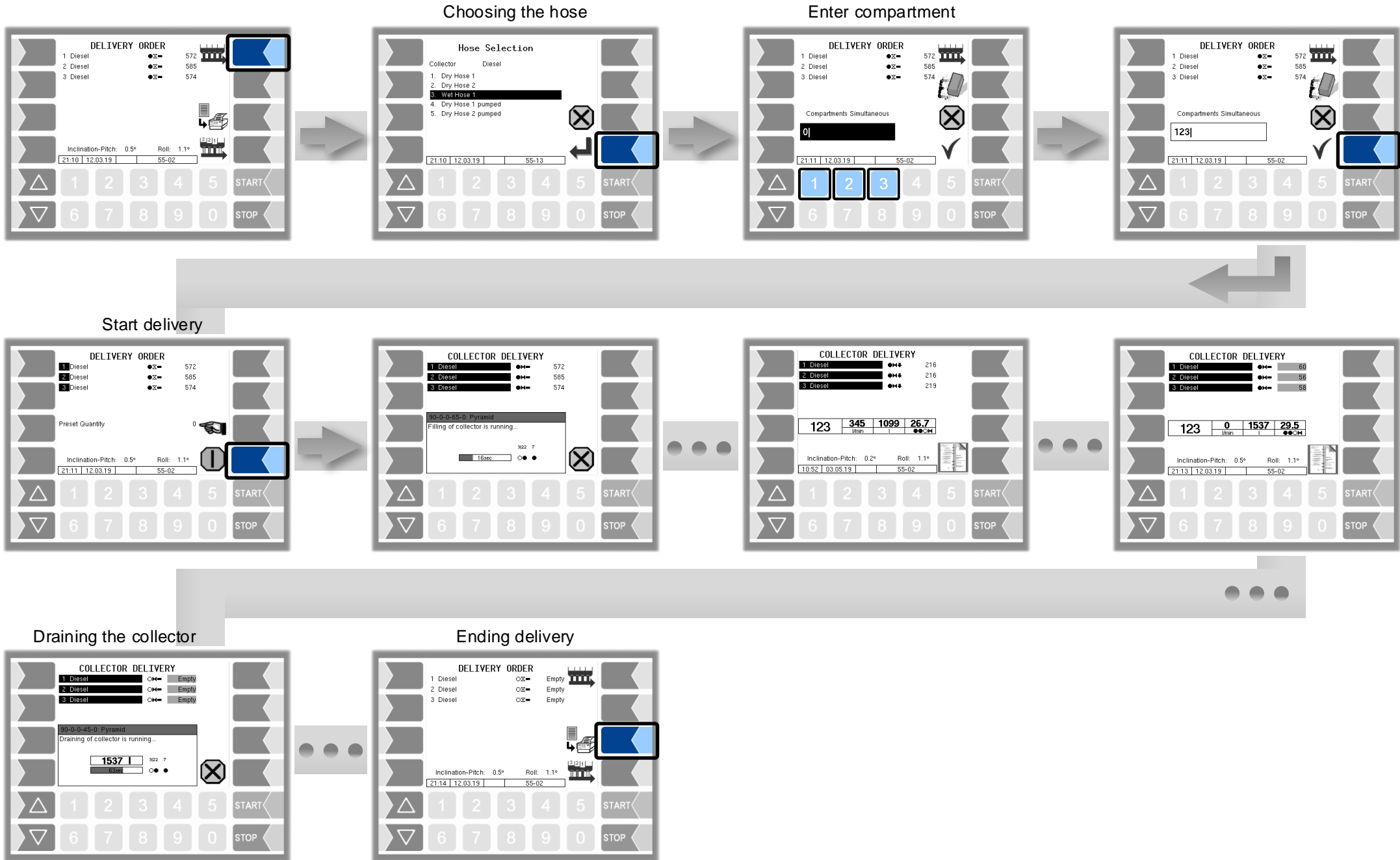

# Wet hose delivery seriell

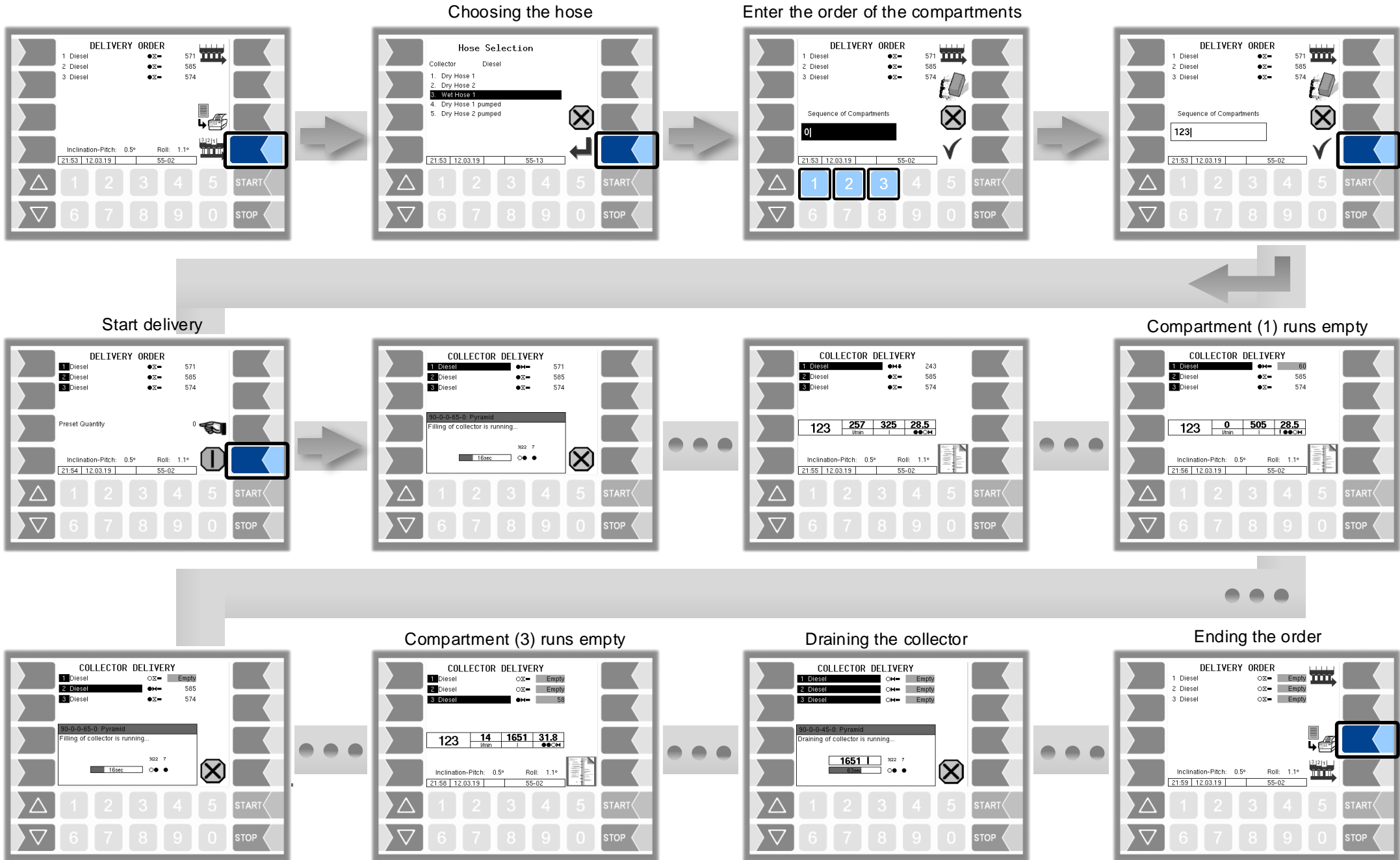

# Wet hose part delivery

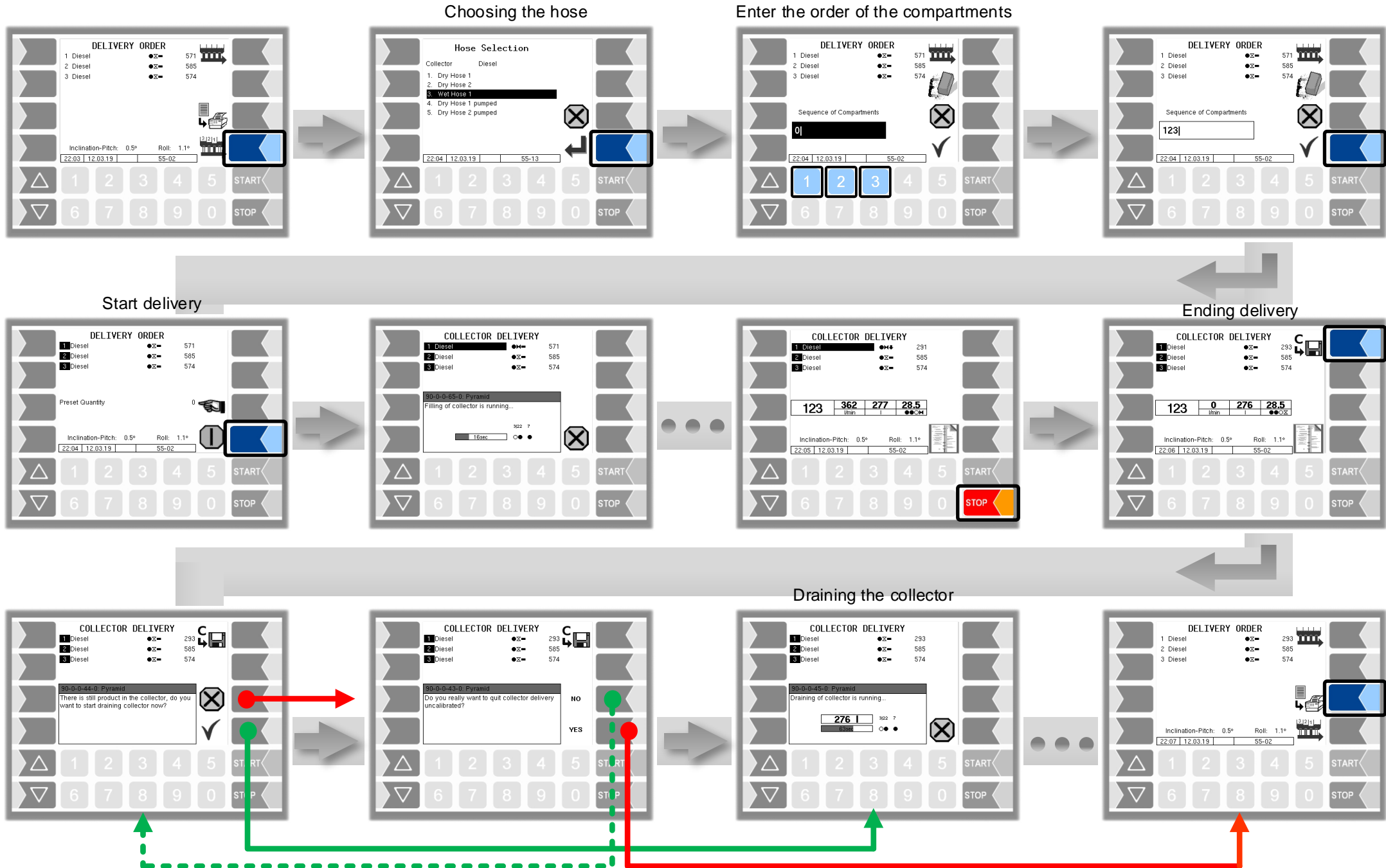



# Collector draining

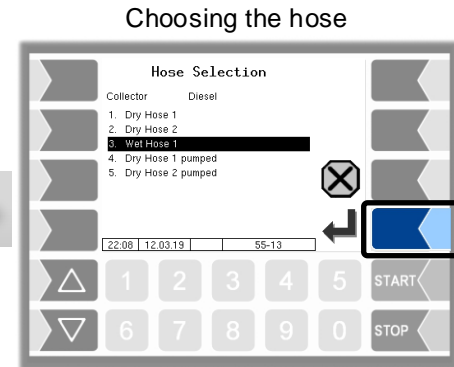
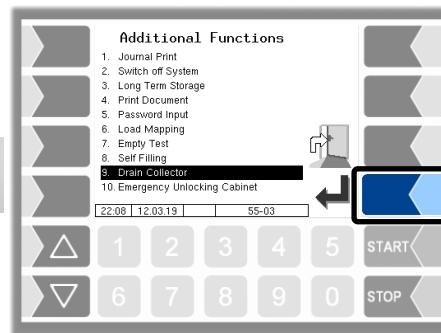
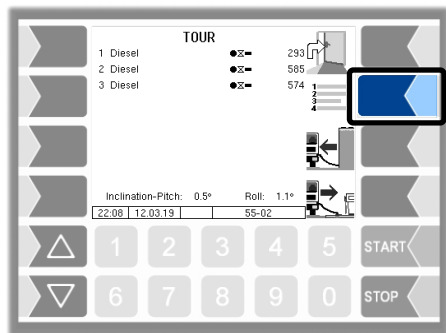

## Draining the collector

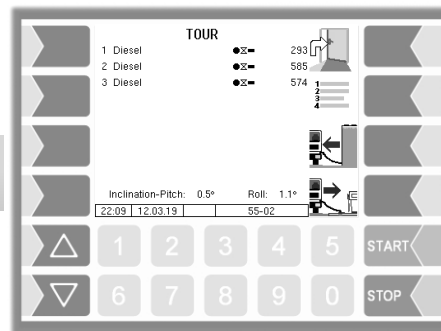
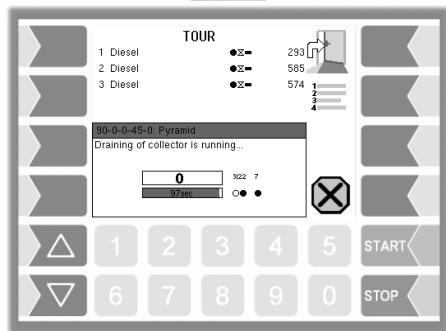

# Display of operating states

