

DL-NW-PTD-ET accessories

Cable glands accessories



Installation

Hazardous areas – Zone 1 / 2 (Gases) – Zone 21 / 22 (Dusts)

Classification

Group II – Category 2G 2D

Mechanical characteristics

Locknuts	
Material	Nichel plated brass
Finishes	Full nickel plating treatment (brass material only)

Shrouds	
Material	PVC*
*EPDM rubber on request	

Gaskets	
Material	Nylon 6.0

Earth tags	
Material	Stainless steel (for stainless cable glands) Nickel plated brass (for nickel plated brass cable glands)

Applications

Locknuts	Are preferred items used in securing cable glands to the gland plate especially to plastic junction boxes
Shrouds	For all tipe of glands application where additional protection is required
Epoxy compound kit	Is provided for submission of barrier cable glands type P.-B. Kit composed of: <ul style="list-style-type: none"> – Component A (resin) – Component B (hardener) – Nitryle gloves – Processing spatula – Istruccion to use
Gaskets	Are used to maintain the ip rating across the interface between the equipment and relevant cable gland
Earth tags	Are used to ensure earth continuity and grounding of cable armour

Technical Features

Locknuts				Gaskets				Washers		
Detail A	Threads / Size			Detail B	Threads / Size			Type	ØD [mm]	Detail
Type	NPT	UNI-228	ISO	Type	NPT	UNI-228	ISO			
DL0	3/8"	3/8"	M16	NW0	3/8"	3/8"	M16	M20	20	C
DL1	1/2"	1/2"	M20	NW1	1/2"	1/2"	M20	M25	25	C
DL2	3/4"	3/4"	M25	NW2	3/4"	3/4"	M25	M32	32	C
DL3	1"	1"	M32	NW3	1"	1"	M32	M40	40	C
DL4	1-1/4"	1-1/4"	M40	NW4	1-1/4"	1-1/4"	M40	M50	50	C
DL5	1-1/2"	1-1/2"	M50	NW5	1-1/2"	1-1/2"	M50	M63	63	C
DL6	2"	2"	M63	NW6	2"	2"	M63			
DL7	2-1/2"	2-1/2"	M75	NW7	2-1/2"	2-1/2"	M75			
DL8	3"	3"	M90	NW8	3"	3"	M90			
DL9	4"	4"	M100	NW9	4"	4"	M100			

Shrouds*				Earths tags				Flowable epoxy resin RSN#C0200	
Detail D	Threads / Size			Detail E	Threads / Size			Cable gland size	Resin quantity [g]
Type	NPT	UNI-228	ISO	Type	NPT	UNI-228	ISO		
PTD0	3/8"	3/8"	M16	ET0	3/8"	3/8"	M16	0	4
PTD1	1/2"	1/2"	M20	ET1	1/2"	1/2"	M20	1	7
PTD2	3/4"	3/4"	M25	ET2	3/4"	3/4"	M25	2	12
PTD3	1"	1"	M32	ET3	1"	1"	M32	3	21
PTD4	1-1/4"	1-1/4"	M40	ET4	1-1/4"	1-1/4"	M40	4	36
PTD5	1-1/2"	1-1/2"	M50	ET5	1-1/2"	1-1/2"	M50	5	53
PTD6	2"	2"	M63	ET6	2"	2"	M63	6	86
PTD7	2-1/2"	2-1/2"	M75	ET7	2-1/2"	2-1/2"	M75	7	159
PTD8	3"	3"	M90	ET8	3"	3"	M90	8	250
PTD9	4"	4"	M100	ET9	4"	4"	M100	9	533

* Blue colour on request.

Det. A

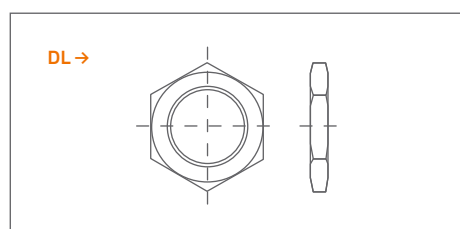

Det. B

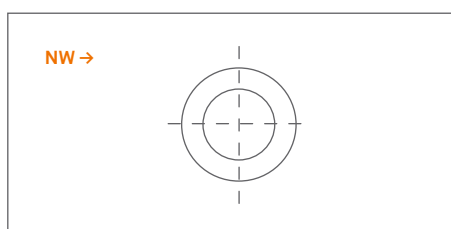

Det. C

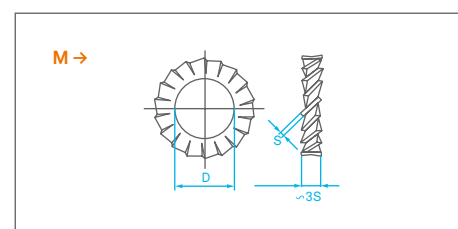

Det. D

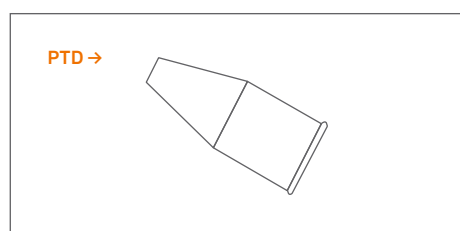

Det. E

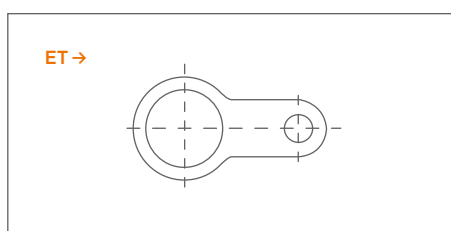

Epoxy paste

