

Polaris Remote

for Zone 1 and 21

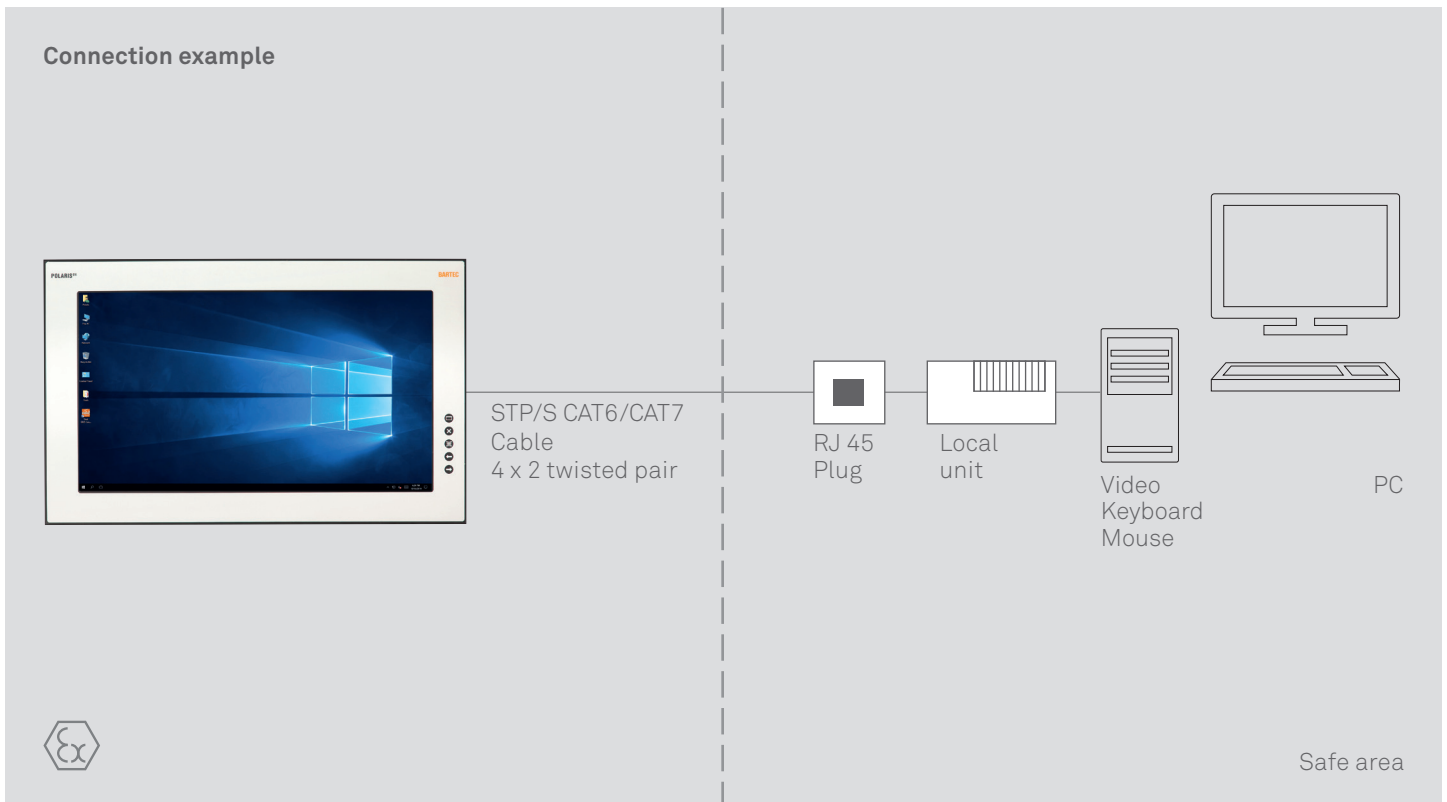

The POLARIS Remote unit by BARTEC is a display which a PC can be operated in safe areas of hazardous areas. Distances of up to 20 km are possible. POLARIS Remote offers the user the possibility of using any currently available PC-based process control system, without any restrictions in the Ex area.

The front panel installation assures ease of mounting. On request, the devices are also available as turn-key system solutions in a Stainless-steel enclosure as wall and floor mounting versions. Intrinsically safe input devices can also be connected. The optional touchscreen (intrinsically safe) offers the ultimate in operating comfort. Connection in the safe area is realised via a local unit (included in scope of delivery).

- Easy front panel fitting
- Easy wiring
- Connection of standard PCs in non-hazardous areas
- Optional touchscreen
- Transmission through fibre optical



POLARIS Remote 15"



POLARIS Remote 15" Sunlight

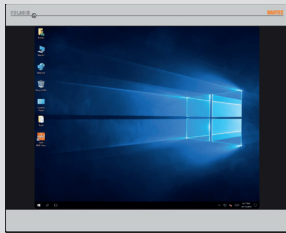

POLARIS Remote 19.1"



POLARIS Remote 17.3" W



POLARIS Remote 24" W

Explosion protection

ATEX Ex protection type	Ⓔ Ex II 2G Ex db eb q [ib op pr] IIC T4 Gb Ⓔ Ex II 2D Ex tb IIIC T120 °C Db
ATEX certificate number	IBExU 05 ATEX 1117 X
IECEX Ex protection type	Ex db eb q [ib op pr] IIC T4 Gb Ex tb IIIC T120 °C Db
IECEX certificate number	IECEX IBE 11.0007 X

Other approvals and certificates, see bartec.com

Technical data

Construction	Front-panel fitting
Degree of protection	IP 65 (front) IP 54 (back)
Cable length	POLARIS: terminals in the Ex e chamber Local unit: RJ45 connector Up to 100 m via STP copper cable DVI/USB Optical fibre version POLARIS: ST connector Local unit: LC connector Up to 500 m via multi-mode optical fibre (50 µm/125) DVI/USB Up to 20 km via single-mode optical fibre (9/125 µm) DVI/USB
Optional accessories	Hand-held scanner on request
Supply voltage	DC 24 V ± 10 % AC 100 to 230 V, 50 or 60 Hz
Max. power consumption	P _{max} < 60 W
Admissible ambient temperatures	Storage -20 °C to +50 °C Operation 0 °C to +50 °C System solution with heating on request. for 15" Sunlight: Storage -20 °C to +60 °C Operation -20 °C to +60 °C System solution with heating on request.
Relative air humidity	5 to 95 % non-condensing
Vibration	0.7 g/1 mm; 5 Hz to 500 Hz pulse in all 3 axes
Shock	15 g/11 ms pulse in all 3 axes
Material	Front: polyester foil on anodised aluminium plate (conditionally UV-resistant) Back: bichromated sheet steel
KVM connection to the PC	Via local unit

Technical data

POLARIS	Remote 15"	Remote 15" Sunlight	Remote 19.1"	Remote 17.3" W	Remote 24" W
Display					
Graphics-capable TFT colour display	15"	15"	19.1"	17.3" W	24" W
Colours	16.7 million	16.7 million	16.7 million	16.7 million	16.7 million
Resolution	XGA 1024 x 768 pixels	XGA 1024 x 768 pixels	SXGA 1280 x 1024 pixels	Full HD 1920 x 1080 pixels	Full HD 1920 x 1080 pixels
Brightness	350 cd/m ²	1000 cd/m ²	300 cd/m ²	400 cd/m ²	300 cd/m ²
Visible area approx.	304 x 228 mm	304 x 228 mm	380 x 305 mm	382 x 215 mm	531 x 299 mm
Contrast	700:1	700:1	1300:1	600:1	3000:1
Antireflection-coated glass pane	yes	yes	yes	yes	yes
Touchscreen (resistive)	yes	yes	optional	yes	optional
Backlighting	LED technology	LED technology	LED technology	LED technology	LED technology
Service life approx. (at +25 °C)	50,000 hours	50,000 hours	50,000 hours	50,000 hours	50,000 hours
Dimensions					
Dimensions (W x H x D in mm)	411 x 332 x approx. 135	411 x 332 x approx. 135	498 x 400 x approx. 135	503 x 314 x approx. 135	644 x 406 x approx. 135
Wall cut-out (in mm)	394.5 x 315.5 + 0.5	394.5 x 315.5 + 0.5	484 x 386.5 + 0.5	489 x 301 + 0.5	630 x 392 + 0.5
Weight	approx. 12 kg	approx. 12 kg	approx. 15 kg	approx. 15 kg	approx. 21 kg

Order details

1 7 - 7 1 V 2 - A A B B / 0 0 C 0	
AA	Designation 60 – Remote 15" with touchscreen 62 – Remote 15" Sunlight with touchscreen 50 – Remote 19.1" without touchscreen 70 – Remote 19.1" with touchscreen F0 – Remote 17.3" W with touchscreen C0 – Remote 24" W without touchscreen D0 – Remote 24" W with touchscreen
BB	Interfaces 17 – for STP/S copper cable (up to max. 100m) on request - for 50 µm multi-mode optical fibre cable (up to max. 500 m) on request - up to 20 km via single-mode optical fibre cable
C	Version 0 – AC 90 to 253 V 2 – DC 24 V